



MED

MINE EXTRACTION DEVICE



Available in 210 and 360 tonne rated capacities

Elphinstone Mine Extraction Device (MED)
elphinstone.com

ELPHINSTONE

UNDERGROUND RELIABILITY



ELIMINATES UNSAFE EXTRACTIONS

Use fit-for-purpose equipment during extractions

The Elphinstone Mine Extraction Device (MED) has been designed, manufactured and engineer certified with a pulling capacity of up to 360 Tonnes.

The Mine Extraction Device was invented in response to requests from underground miners having difficulties extracting buried equipment without damaging the mine or negatively impacting production.

The MED has performed hundreds of successful extractions at a number of underground mining operations (both coal and hard rock) across Australia and internationally.

Minimises disruptions to mining operations

Production disruptions are minimised by eliminating the need to deploy production equipment to assist in recoveries as well as minimising interactions with bogged or buried equipment.

The MED eliminates the need for traditional recovery methods that involve the use of other mobile equipment,

which reduces the hazards associated with personnel working around mobile equipment in close quarters and allows other mining operations to continue relatively uninterrupted.

What makes the MED so unique?

The Mine Extraction Device does not rely on traction like other systems. After the MED is towed into position and the boom is raised against the roof, the wheels are lowered on the floor. A bridle is interlocked onto the teeth of the MED racks. These MED racks are then pulled via hydraulic cylinders.

This is in contrast to using wheeled or tracked tow vehicles that can result in damage to the machines, the mine infrastructure, all of which can add further delays to the restart of production.

Insurance supports the proven MED system

The unique retrieval system has the support of numerous insurance companies with the recognition that if this system cannot retrieve a buried loader then the loader is not retrievable.



PULLER CAPABILITIES & SPECIFICATIONS

Three power-packed levels of pulling capacity

The Mine Extraction Device is available in 210-tonne, and 360-tonne capacities, developed in line with industry growth. (Older configurations still supported).

In addition to the retrieval of buried equipment, the higher capacity models are also capable of extracting drill rods embedded in the rock face.

Features Include:

- » Pulling capacity of up to 360 Tonnes.
- » The extendable boom allows use in a range of underground operations.
- » Easily towed into place.
- » Operating pressure (Max) 180 Bar, flow rate of 40-100 litres per minute.
- » Control pedestal and pilot valve.
- » Optional remote control.
- » Winch to assist rack positioning.
- » Cranes to assist positioning racks (MED360 only)





STANDARD AND OPTIONAL EQUIPMENT

● Standard ● Optional

| Description | Qty | MED210 | MED360 |
|---|-----------------|--------|--------|
| Arm Lift Ram Safety Lock | 1 | | ● |
| Base Machine | 1 | ● | ● |
| Boom Extension, 4m (13.1 ft) | 1 | ● | |
| Boom Extension, 5m (16.4 ft) | 1 | ● | |
| Boom Extension, 6m (19.6 ft) | 1 | ● | ● |
| Boom Extension, Adjustment Link | 1 | | ● |
| Connecting Link, D-shackle | 1 | ● | ● |
| Control Bank | 1 | ● | ● |
| Head Plate, Flat | 1 | ● | ● |
| Head Plate, Curved | 1 | ● | ● |
| Hose Storage Rack | 1 | ● | ● |
| Hydraulic Hoses, Machine to Control Bank | 10m /32ft 9.6in | ● | ● |
| Hydraulic Hoses, Control Bank to Power Pack | 10m/ 32ft 9.6in | ● | ● |
| Hydraulic Power Pack | 1 | ● | ● |
| Hydraulic Winch | 1 | ● | ● |
| Rack, 1000 mm (39.4 in) | 10 | ● | ● |
| Rack, 2000 mm (78.7 in) | 1 | | |
| Rack, Pin | 10 | ● | ● |
| Rack, Transport box | 1 | ● | ● |
| Rack, Lifting Tool | 1 | ● | |
| Shipping Container, 20 foot | 1 | ● | |
| Shipping Container, 20 foot | 2 | ● | ● |
| Tow Bar | 1 | ● | ● |
| Tow Bar, Connection Pin | 1 | ● | ● |

| Operation | MED210 | MED360 |
|--------------------------|--------------|--------------|
| Operating Pressure (Max) | 180 bar | 180 bar |
| Operating Flow Rate | 40-100 L/min | 40-100 L/min |

Diagram for reference purposes only

Model pictured: MED210

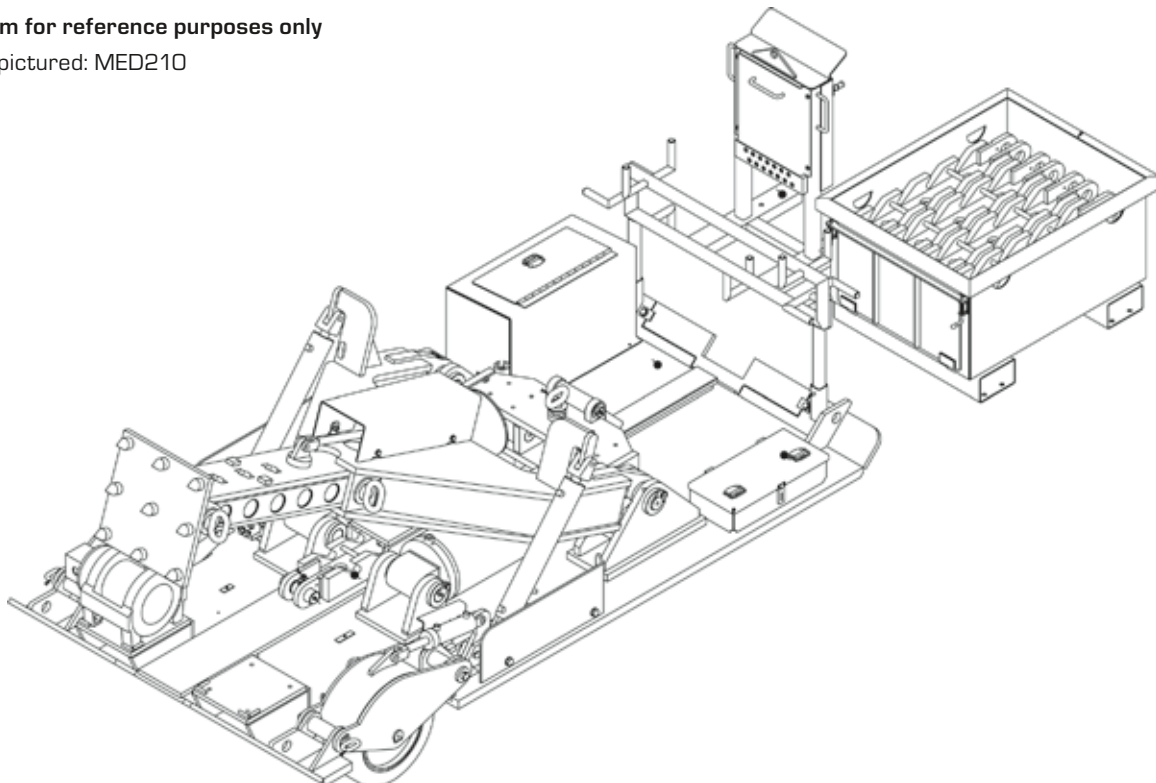
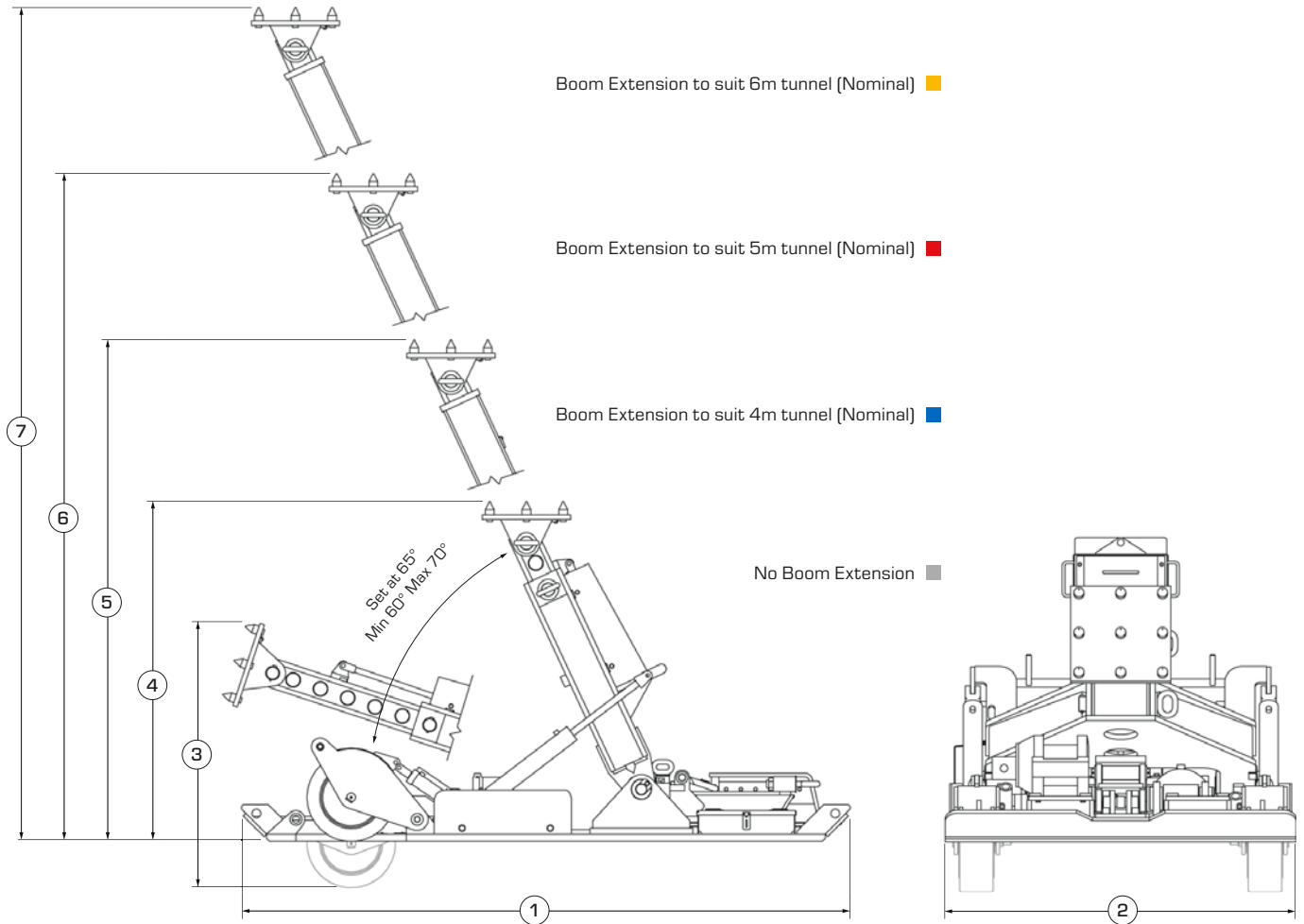



Diagram for Reference Purposes Only



Dimensions

| | MED210 | | MED360 | |
|---|---------|--------------|---------|---------------|
| 1 Length | 4142 mm | 13 ft 7.1 in | 4720 mm | 15 ft 5.8 in |
| 2 Width | 2100 mm | 6 ft 10.6 in | 2300 mm | 7 ft 6.9 in |
| 3 Height - Ground to Head Plate - Retracted for Transport | 1830 mm | 6 ft | 1940 mm | 6 ft 4.4 in |
| 4 Height - Retracted (No Boom Extension) | 2320 mm | 7 ft 7.3 in | 2800 mm | 9 ft 2.2 in |
| | 3030 mm | 9 ft 11.2 in | 3550 mm | 11 ft 7.8 in |
| 5 Height - Retracted with Standard 4m Boom Extension (13.1 ft) | 3470 mm | 11 ft 4.6 in | 3510 mm | 11 ft 6.2 in |
| | 4290 mm | 14 ft 0.9 in | 4550 mm | 14 ft 11.1 in |
| 6 Height - Retracted with Standard 5m Boom Extension (16.4 ft) | 4460 mm | 14 ft 7.6 in | 4480 mm | 14 ft 8.4 in |
| | 5360 mm | 17 ft 7.0 in | 5600 mm | 18 ft 4.5 in |
| 7 Height - Retracted with Standard 6m Boom Extension (19 ft 8.2 in) | 5430 mm | 17 ft 9.8 in | 5130 mm | 16 ft 9.1 in |
| | 6410 mm | 21 ft 0.4 in | 6300 mm | 20 ft 8.0 in |
| Height - Ground to HIAB Crane Knuckle (Packed Up - MED360 only) | N/A | | 2195 mm | 7 ft 2.4 in |

Weights

| | MED210 | | MED360 | |
|--------------------------|---------|------------|-----------|------------|
| Machine Total Mass* | 9260 kg | 20414.8 lb | 15,655 kg | 34513.3 lb |
| Rack (1000 mm / 39.4 in) | 103 kg | 227 lb | 288 kg | 634.9 lb |
| Rack (2000 mm / 78.7 in) | - | - | - | - |
| Pin | 6 kg | 13.2 lb | 11 kg | 24.3 lb |
| Rack Box | 325 kg | 716.5 lb | 660 kg | 1455 lb |

*Total mass excludes vendor parts

OVER 45 YEARS IN THE MINING INDUSTRY.

Elphinstone Pty Ltd is an established Caterpillar OEM Solutions customer with over 45 years' experience in the mining industry.

Elphinstone specialises in the design, manufacture and support of quality equipment for the global underground and surface mining industries.

The Elphinstone range of products combines practical design, the latest technology and quality manufacturing to ensure reliable performance.

The current product range includes specialised underground support vehicles, mine extraction devices, extended distance off-highway haulage trucks and water tanks customised to suit Caterpillar articulated trucks.

All Elphinstone products, technical assistance, support, and access to spare parts are available through the global Cat® dealer network with additional support from the Elphinstone regional sales and support team.

MINE EXTRACTION DEVICE

For more complete information on Elphinstone products, dealer services, and industry solutions, visit www.elphinstone.com or contact your local Cat® dealer.

Material and specifications are subject to change without notice. Featured machines in photos may include additional equipment.

Elphinstone and their respective logos, as well as corporate and product identity used herein, are trademarks of Elphinstone and may not be used without permission.

© 2024 Elphinstone. All rights reserved.
Made in Australia for export.

ELPHINSTONE



HM62782-10 (03-2025)